

2.8.3 Fire rated mortar

Component		PASSIVE FIRE PROTECTION SYSTEMS
Sub-component		Fire rated mortar
Need	Infill of floor penetration with lightweight fire rated mortar.	
Requirement	<p>General</p> <ul style="list-style-type: none"> To current Australian Standards Lightweight fire penetration mortar for fire sealing of penetrations in existing floors <p>Performance</p> <ul style="list-style-type: none"> Required Fire Resistance Level to match floor specification in accordance with AS1530.4 with reference to AS4072.1 Installed system must be compliant to BCA Clause C3.15(a) for the service type and size being protected. Where required for compliance with this clause, the service shall be wrapped with an appropriate or tested insulating wrapping <p>Installation</p> <ul style="list-style-type: none"> Install in accordance with manufacturing instruction including any additional requirements to suit the substrate as per manufactures fire test approval. Noting that fire rated mortars are not load bearing, appropriate provision must be made to prevent foot traffic or loading of all penetrations <p>Certification</p> <ul style="list-style-type: none"> As per Work Requirements Penetration sticker installed adjacent to the penetration including following information: <ul style="list-style-type: none"> Installation Company Installer Date of installation (m/y) FRL ID number Report No. Certificate of compliance 	
Warranty	Minimum N/A year written warranty – Penetration seal system.	

2.8.4 Fire rated sealant

Component		PASSIVE FIRE PROTECTION SYSTEMS
Sub-component		Fire rated sealant
Need	Fire sealing of penetrations in walls or floors to suit penetration size and type.	
Requirement	<p>General</p> <ul style="list-style-type: none"> To current Australian Standards Mastic type fire sealant for sealing of penetrations in walls or floors to suit penetration size and type Covers both standard and high performance/pressure type sealants as appropriate to penetration type <p>Performance</p> <ul style="list-style-type: none"> Required Fire Resistance Level to match floor or wall specification in accordance with AS1530.4 with reference to AS4072.1 Installed system must be compliant to BCA Clause C3.15(a) for the service type and size being protected. Where required for compliance with this clause, the service shall be wrapped with an appropriate or tested insulating wrapping <p>Installation</p> <ul style="list-style-type: none"> Install in accordance with manufacturing instruction including any additional requirements to suit the substrate as per manufactures fire test approval Where possible sealant colour must be appropriately match to substrate colour <p>Certification</p> <ul style="list-style-type: none"> As per Work Requirements Penetration sticker installed adjacent to the penetration including following information: <ul style="list-style-type: none"> Installation Company Installer Date of installation (m/y) FRL ID number Report No. Certificate of compliance 	
Warranty	Minimum 2 year written warranty – Penetration seal system.	

2.8.5 Fire rated expansion foam

Component		PASSIVE FIRE PROTECTION SYSTEMS
Sub-component		Fire rated expanding foam
Need	Fire sealing of penetrations in walls or floors to suit penetration size and type.	
Requirement	<p>General</p> <ul style="list-style-type: none"> To current Australian Standards Fire rated expanding foam for sealing of penetrations in walls or floors to suit penetration size and type <p>Performance</p> <ul style="list-style-type: none"> Required Fire Resistance Level to match floor or wall specification in accordance with AS1530.4 with reference to AS4072.1 Installed system must be compliant to BCA Clause C3.15(a) for the service type and size being protected. Where required for compliance with this clause, the service shall be wrapped with an appropriate or tested insulating wrapping. Note, fire rated expanding foams have very limited fire testing approvals with respect to penetration types and attention must be paid to ensure foam is only used to seal tested penetration types <p>Installation</p> <ul style="list-style-type: none"> Install in accordance with manufacturing instruction including any additional requirements to suit the substrate as per manufactures fire test approval <p>Certification</p> <ul style="list-style-type: none"> As per Work Requirements. Penetration sticker installed adjacent to the penetration including following information: <ul style="list-style-type: none"> Installation Company Installer Date of installation (m/y) FRL ID number Report No. Certificate of compliance 	
Warranty	Minimum 2 year written warranty – Penetration seal system.	

2.8.6 High Density mineral fibre batts

Component		PASSIVE FIRE PROTECTION SYSTEMS
Sub-component		High Density mineral fibre batts
Need	Sealing of penetrations in walls and ceilings.	
Requirement	<p>General</p> <ul style="list-style-type: none"> To current Australian Standards High density mineral fibre batt as a penetration barrier for temporary or permanent fire sealing of penetrations in wall or floor <p>Performance</p> <ul style="list-style-type: none"> Required Fire Resistance Level to match wall or floor specification in accordance with AS1530.4 with reference to AS4072.1 Installed system must be compliant to BCA Clause C3.15(a) for the service type and size being protected. Where required for compliance with this clause, the service shall be wrapped with an appropriate or tested insulating wrapping <p>Installation</p> <ul style="list-style-type: none"> Install in accordance with manufacturing instruction including any additional requirements to suit the substrate as per manufactures fire test approval Seal any resulting annual gaps between services and the batt, and the batts themselves using applicable fire rated sealant for the pillow type <p>Certification</p> <ul style="list-style-type: none"> As per Work Requirements Penetration sticker installed adjacent to the penetration including following information: <ul style="list-style-type: none"> Installation Company Installer Date of installation (m/y) FRL ID number Report No. Certificate of compliance 	
Warranty	Minimum 1 year written warranty – Penetration seal system.	

2.9 Door hold open device

Component	DOOR HOLD OPEN DEVICE
Sub-component	Electromagnetic door hold open device
Need	Replacement of existing electromagnetic hold open device
Requirement	<p>General</p> <ul style="list-style-type: none"> • To current Australian Standards • Electromagnetic hold open device and associated smoke detector to serve fire or smoke door in accordance with BCA Clause C3.5 <p>Performance</p> <ul style="list-style-type: none"> • Holding force equal or greater than original unit • 24Vdc or 240Vac as applicable, ensuring current draw is suitable for panel or supply device • Smoke detector shall meet the requirements applicable technical specification including AS1670.1 <p>Material and/or Manufacture</p> <ul style="list-style-type: none"> • Steel or plastic body • Water/dust ingress rating (IP) must be suitable for the installation environment • Fixings must be suitable for the installation environment <p>Installation</p> <ul style="list-style-type: none"> • Install in accordance with manufacturing instruction including required fixing detail appropriate to the installation substrate <p>Certification</p> <ul style="list-style-type: none"> • As per Work Requirements • Baseline data/modification to THE PRINCIPAL'S inventory records including modification to AS1670.1 – Section A.4 • Functional check to be conducted in accordance with AS1670.1 – Section A.3
Warranty	Minimum 1 year written warranty

2.10 Signage

2.10.1 Fire door signage

Component		SIGNAGE
Sub-component		Signage for fire door
Need	Replacement of existing fire door signage as required by BCA	
Requirement	<p>General</p> <ul style="list-style-type: none"> To current Australian Standards Fire Door Signage as required by BCA Clause D2.23 <p>Performance</p> <ul style="list-style-type: none"> Meets the requirement of BCA Clause D2.23, including: <ul style="list-style-type: none"> Location Wording appropriate to application Font size minimum 20mm Colour <p>Material and/or Manufacture</p> <ul style="list-style-type: none"> Construction as suitable to application: <ul style="list-style-type: none"> Vinyl sticker PVC plastic Colourbond metal Fixings must be suitable for the installation environment PVC plastic and metal signs mechanically fixed with vandal resistant non corrosive screws <p>Installation</p> <ul style="list-style-type: none"> Permanent fixing detail appropriate to the installation substrate <p>Certification</p> <ul style="list-style-type: none"> As per Work Requirements 	
Warranty	Minimum N/A year written warranty – Sign	

2.10.2 Evacuation Signage

Component		SIGNAGE
Sub-component		Occupant Evacuation Signage
Need	Replacement of existing occupant evacuation signage	
Requirement	<p>General</p> <ul style="list-style-type: none"> To current Australian Standards Occupant evacuation signage for installation on the inside of the SOU entry door or in common areas as applicable <p>Performance</p> <ul style="list-style-type: none"> Shall meet the requirements of the Principal's Fire Safety Manual and shall include at a minimum the following information: <ul style="list-style-type: none"> R.A.C.E acronym and pictorial representation Evacuation procedure In an emergency dial 000 Block plan showing location of assembly area <p>Material and/or Manufacture</p> <ul style="list-style-type: none"> Construction as suitable to application: <ul style="list-style-type: none"> Vinyl sticker PVC plastic Colourbond metal Where vinyl or PVC are used in common areas they shall be provided with a minimum 2mm sheet of Perspex Fixings must be suitable for the installation environment PVC plastic and metal signs mechanically fixed with vandal resistant non corrosive screws <p>Installation</p> <ul style="list-style-type: none"> Permanent fixing detail appropriate to the installation substrate <p>Certification</p> <ul style="list-style-type: none"> As per Work Requirements 	
Warranty	Minimum N/A year written warranty – Sign	

2.10.3 Fire Hose Reel & Extinguisher Signage

Component		SIGNAGE
Sub-component		Fire hose reel & Extinguisher signage
Need	Replacement of existing Fire hose reel & Extinguisher signage	
Requirement	<p>General</p> <ul style="list-style-type: none"> To current Australian Standards Fire hose reel & Extinguisher signage required by relevant standards <p>Performance</p> <ul style="list-style-type: none"> Identification signage for Fire Hose Reel systems – In accordance with AS2441 – Section 10.4 Identification signage for Portable extinguisher systems – In accordance with AS2444 – Section 10.4 <p>Material and/or Manufacture</p> <ul style="list-style-type: none"> Height and location of signage in accordance with applicable standard Construction as suitable to application: <ul style="list-style-type: none"> PVC plastic Colourbond metal Fixings must be suitable for the installation environment PVC plastic and metal signs mechanically fixed with vandal resistant non corrosive screws <p>Installation</p> <ul style="list-style-type: none"> Permanent fixing detail appropriate to the installation substrate <p>Certification</p> <ul style="list-style-type: none"> As per Work Requirements 	
Warranty	Minimum N/A year written warranty – Sign	

2.11 Dampers

2.11.1 Intumescent fire dampers

Component		DAMPERS
Sub-component		Intumescent fire dampers
Need	To prevent transmission of smoke and fire across fire compartments	
Requirement	<p>General</p> <ul style="list-style-type: none"> To current Australian Standards Wall, floor or shaft mounted intumescent fire damper Covers square sizes up to 200mm x 200mm <p>Performance</p> <ul style="list-style-type: none"> Required Fire Resistance Level to match existing fire damper and substrate in accordance with AS1530.4 System shall meet the requirements of AS1682.1 <p>Material and/or Manufacture</p> <ul style="list-style-type: none"> Galvanised steel construction suitable for internal or external applications Fixings must be suitable for the installation environment <p>Installation</p> <ul style="list-style-type: none"> Install in accordance with manufacturing instruction and AS1530.4 requirements including required fixing detail appropriate to the installation substrate Installation standard AS1682.1 – Section 3.2.2.2 including but not limited to: <ul style="list-style-type: none"> Breakaway joints (if required) Fixing angles <p>Certification</p> <ul style="list-style-type: none"> As per Work Requirements Permanent label shall be installed adjacent to the damper in accordance with AS1682.1 Section 1.7 and including following information: <ul style="list-style-type: none"> Manufacture's name or trademark Model number including FRL Orientation (vertical, horizontal or both) Direction of airflow Installer Certificate of compliance 	
Warranty	Minimum 1 year written warranty – Damper	

2.11.2 Mechanical fire dampers

Component		DAMPERS
Sub-component		Mechanical fire dampers
Need	To prevent transmission of smoke and fire across fire compartments	
Requirement	<p>General</p> <ul style="list-style-type: none"> To current Australian Standards Wall, floor or shaft mounted mechanical fire damper Curtain or blade type as per required application <p>Performance</p> <ul style="list-style-type: none"> Required Fire Resistance Level to match existing fire damper and substrate in accordance with AS1530.4 System shall meet the requirements of AS1682.1 <p>Material and/or Manufacture</p> <ul style="list-style-type: none"> Galvanised steel construction suitable for internal or external applications Fixings must be suitable for the installation environment <p>Installation</p> <ul style="list-style-type: none"> Install in accordance with manufacturing instruction and AS1530.4 requirements including required fixing detail and expansion tolerances appropriate to the installation substrate Installation standard AS1682.1 – Section 3.2.2.2 including but not limited to: <ul style="list-style-type: none"> Breakaway joints (if required). Fixing angles. <p>Certification</p> <ul style="list-style-type: none"> As per Work Requirements Permanent label shall be installed adjacent to the damper in according with AS1682.1 Section 1.7 and including following information: <ul style="list-style-type: none"> Manufacture's name or trademark Model number including FRL. Orientation (vertical, horizontal or both) Direction of airflow Installer Certificate of compliance 	
Warranty	Minimum 2 year written warranty – Damper	

2.11.3 Ceiling Fire Damper Enclosure

Component		DAMPERS
Sub-component		Ceiling Fire Damper Enclosure
Need	Protection of exhaust fan/grill in FR ceiling.	
Requirement	<p>General</p> <ul style="list-style-type: none"> To current Australian Standards Ceiling fire damper enclosure to allow air movement through fire rated ceilings Plenum type (open grill) or Spigot type (duct connect) as applicable to application <p>Performance</p> <ul style="list-style-type: none"> Required Fire Resistance Level to match the ceiling including incipient rating in accordance with AS1530.4 <p>Material and/or Manufacture</p> <ul style="list-style-type: none"> Fixings must be suitable for the installation environment Spigot connection (if require) to match exhaust duct diameter <p>Installation</p> <ul style="list-style-type: none"> Install in accordance with manufacturing instruction and AS1530.4 requirements including required fixing detail and four sided framing appropriate to the ceiling construction <p>Certification</p> <ul style="list-style-type: none"> As per Work Requirements Permanent label shall be installed adjacent to the damper in according with AS1682.1 Section 1.7 and including following information: <ul style="list-style-type: none"> Manufacture's name or trademark Model number including FRL. Direction of airflow Installer Certificate of compliance 	
Warranty	Minimum 2 year written warranty – Damper	

2.12 Fire Blanket

Component		FIRE BLANKET
Sub-component		Fire Blanket
Need	Remove and replacement with new fire blanket	
Requirement	<p>General</p> <ul style="list-style-type: none"> • To current Australian Standards • Fit only where directed by Principal • Fixed permanently into the common area room kitchen wall only • Fire blanket with dimensions 1.2m x 1.8m <p>Performance</p> <ul style="list-style-type: none"> • Complies with AS/NZS 3504 • Location in accordance with AS2444 <p>Material and/or Manufacture</p> <ul style="list-style-type: none"> • Container – Signal red in colour • Fixings must be suitable for the installation environment • Signage shall be in accordance with technical specification for signage and the requirements of AS2444 – Section 6.4.4 <p>Installation</p> <ul style="list-style-type: none"> • Installed in accordance with manufacturing instruction and in accordance with AS2444 – Section 6 • Signage shall be installed in accordance with AS2444 – Section 6.4.2, including: <ul style="list-style-type: none"> ○ Not below 2000mm from FFL <p>Certification</p> <ul style="list-style-type: none"> • As per Work Requirements 	
Warranty	Minimum 5 year written warranty	

2.13 Fire Indicator Panel

2.13.1 FIP replacement components

Component		FIRE INDICATOR PANEL
Sub-component		FIP replacement components
Need	Replacement of components in existing FIP system	
Requirement	<p>General</p> <ul style="list-style-type: none"> • To current Australian Standards • Covers the replacement of the following items on an existing Fire Indicator Panel: <ul style="list-style-type: none"> ○ Vandal resistant panel door ○ Power supply ○ Single and double loop cards ○ LCD screen ○ Conventional zone card ○ Fan Control interface module <p>Performance</p> <ul style="list-style-type: none"> • All items must be of a type to match the currently installed Fire Indicator Panel • Power supply, must be of appropriate voltage and current to match panel and device requirements <p>Material and/or Manufacture</p> <ul style="list-style-type: none"> • Panel door <ul style="list-style-type: none"> ○ Steel body ○ Perspex viewing window ○ 003 key type lock <p>Installation</p> <ul style="list-style-type: none"> • Install in accordance with manufacturing instruction <p>Certification</p> <ul style="list-style-type: none"> • As per Work Requirements 	
Warranty	Minimum 1 year written warranty – System	

2.13.2 Occupant warning amplifier

Component		FIRE INDICATOR PANEL
Sub-component		Occupant warning amplifier
Need	Replacement of existing occupant warning amplifier	
Requirement	<p>General</p> <ul style="list-style-type: none"> To current Australian Standards Covers occupant warning amplifiers from 25w to 150w <p>Performance</p> <ul style="list-style-type: none"> Amplifier must be of appropriate voltage and current to match panel and device requirements <p>Material and/or Manufacture</p> <ul style="list-style-type: none"> Where required module to be installed in appropriate 19 inch rack mount to suit panel enclosure <p>Installation</p> <ul style="list-style-type: none"> Install in accordance with manufacturing instruction <p>Certification</p> <ul style="list-style-type: none"> As per Work Requirements 	
Warranty	Minimum 1 year written warranty – System	

2.13.3 FIP / EWIS Battery

Component		FIRE INDICATOR PANEL
		FIP/EWIS batteries
Need	Replacement of existing batteries in FIP or EWIS panel	
Requirement	<p>General</p> <ul style="list-style-type: none"> • To current Australian Standards • 12v valve regulated lead acid battery • Covers amp hour rating from 15 to 130Ah <p>Performance</p> <ul style="list-style-type: none"> • Must comply with the requirements of AS4029.2 <p>Material and/or Manufacture</p> <ul style="list-style-type: none"> • Body made of ABS • Battery terminals to be appropriate to panel type: <ul style="list-style-type: none"> ○ Male spade connections ○ Female threaded terminals <p>Installation</p> <ul style="list-style-type: none"> • Install in accordance with manufacturing instruction <p>Certification</p> <ul style="list-style-type: none"> • As per Work Requirements 	
Warranty	Minimum 1 year written warranty	

2.13.4 Flow switch sensor system

Component		FIRE INDICATOR PANEL
Sub-component		Flow switch system
Need	Replacement of existing Flow switch sensor system where solenoid is damaged	
Requirement	<p>General</p> <ul style="list-style-type: none"> • To current Australian Standards • Waterflow alarm switch for sprinkler system • Covers all sizes of pipe <p>Performance</p> <ul style="list-style-type: none"> • Must comply with the performance requirements of AS2118.1 • Relay contact rating and configuration to match existing unit <p>Material and/or Manufacture</p> <ul style="list-style-type: none"> • Body made of valve set to be brass or galvanised steel • External relay/termination casing to be red ABS or similar plastic housing with an IP rating suitable for the required installation environment <p>Installation</p> <ul style="list-style-type: none"> • Install in accordance with manufacturing instruction <p>Certification</p> <ul style="list-style-type: none"> • As per Work Requirements 	
Warranty	Minimum 2 year written warranty – System	

2.13.5 Occupant warning speakers

Component		FIRE INDICATOR PANEL
Sub-component		Occupant Warning Speakers
Need	Speaker system to provide occupant warning system notification	
Requirement	<p>General</p> <ul style="list-style-type: none"> To current Australian Standards Occupant warning sounder, covering the following types: <ul style="list-style-type: none"> Surface mount Flush mount Surface mount horn speaker <p>Performance</p> <ul style="list-style-type: none"> Compliant with the requirements of AS1670.4 24Vdc ensuring current draw is suitable for panel or supply device <p>Material and/or Manufacture</p> <ul style="list-style-type: none"> Polycarbonate body Water/dust ingress rating (IP) must be suitable for the installation environment Fixings must be suitable for the installation environment Wire guard/cage shall be either <ul style="list-style-type: none"> Mild steel with corrosion resistant polyester coating (internal) Stainless steel (external) <p>Installation</p> <ul style="list-style-type: none"> Install in accordance with manufacturing instruction <p>Certification</p> <ul style="list-style-type: none"> As per Work Requirements Baseline data/modification to THE PRINCIPAL'S inventory records including modification to AS1670.1 – Section A.4 Functional check to be conducted in accordance with AS1670.1 – Section A.3 	
Warranty	Minimum 2 year written warranty – detector	

2.13.6 ELV Red twin cable

Component		FIRE INDICATOR PANEL
Sub-component		Red twin
Need	Speaker system to provide occupant warning system notification	
Requirement	<p>General</p> <ul style="list-style-type: none"> To current Australian Standards Red twin "TPS" extra low voltage cabling to suit fire systems applications <p>Performance</p> <ul style="list-style-type: none"> Compliant with the requirements of AS1670.1 Cable size or gauge to be sufficient suit application Where utilised for addressable fire panels, detectors and devices cabling shall be twisted pair type Mechanical protection WSX1 <p>Material and/or Manufacture</p> <ul style="list-style-type: none"> PVC best practise certified <p>Installation</p> <ul style="list-style-type: none"> Where required installation shall be to WS 51W specification on fire rated support specification <p>Certification</p> <ul style="list-style-type: none"> As per Work Requirements. 	
Warranty	Minimum 2 year written warranty	

2.14 Visual Alarm Device (VAD)

Component		VISUAL ALARM DEVICE (VAD)
Sub-component		Warning lights
Need	Remove existing fire warning strobe light and replace with new visual alarm device (VAD) to common area	
Requirement	<p>General</p> <ul style="list-style-type: none"> To current Australian Standards Visual alarm device (VAD) <p>Performance</p> <ul style="list-style-type: none"> Compliant with the requirements of AS7240.23 24Vdc or 240Vac as applicable, ensuring current draw is suitable for panel or supply device Ceiling (c), Wall (W) or Open (O) type device as applicable to application If VAD forms part of Building Occupant Warning System (BOWS) coverage shall be at least equal to existing unit and in according to manufactures data and AS1670.1 – Section 3.22 <p>Material and/or Manufacture</p> <ul style="list-style-type: none"> Steel or plastic body Water/dust ingress rating (IP) must be suitable for the installation environment Fixings must be suitable for the installation environment <p>Installation</p> <ul style="list-style-type: none"> Install in accordance with manufacturing instruction including required fixing detail appropriate to the installation substrate <p>Certification</p> <ul style="list-style-type: none"> As per Work Requirements Baseline data/modification to THE PRINCIPAL'S inventory records including modification to AS1670.1 – Section A.4 Functional check to be conducted in accordance with AS1670.1 – Section A.3 	
Warranty	Minimum 1 year written warranty	

2.15 Detectors/alarms

2.15.1 Smoke detector

Component		Detector / Alarms
Sub-component		Smoke detector
Need	Replace with new interconnected photoelectric detector	
Requirement	<p>General</p> <ul style="list-style-type: none"> • To current Australian Standards • Photoelectric type smoke detector with matching base and wire guard • Includes wire guard where required <p>Performance</p> <ul style="list-style-type: none"> • Compliant with the requirements of AS7240.7 and AS1670.1 • 24Vdc ensuring current draw is suitable for panel or supply device • Conventional or analogue addressable to match existing unit • Sensitivity (Obscuration) to match existing unit <p>Material and/or Manufacture</p> <ul style="list-style-type: none"> • Polycarbonate body • Water/dust ingress rating (IP) must be suitable for the installation environment • Fixings must be suitable for the installation environment • Wire guard/cage shall be either <ul style="list-style-type: none"> ○ Mild steel with corrosion resistant polyester coating (internal) ○ Stainless steel (external) <p>Installation</p> <ul style="list-style-type: none"> • Install in accordance with manufacturing instruction including required fixing detail appropriate to the installation substrate <p>Certification</p> <ul style="list-style-type: none"> • As per Work Requirements • Baseline data/modification to THE PRINCIPAL'S inventory records including modification to AS1670.1 – Section A.4 • Functional check to be conducted in accordance with AS1670.1 – Section A.3 	
Warranty	Minimum 5 year written warranty – detector	

2.15.2 Smoke alarm

Component		Detector / Alarms
Sub-component		Smoke alarm
Need	Replace with new interconnected photoelectric smoke alarm	
Requirement	<p>General</p> <ul style="list-style-type: none"> • To current Australian Standards • Photoelectric type smoke alarm • Product listed in CSIRO's Activfire Register of Fire Protection Equipment • Surface mounted (not recessed) • Inter-linkable features • Branded with manufacturers trademark to AS3786 Includes hardwired and wireless interconnection alarms • Includes wire guard where required <p>Performance</p> <ul style="list-style-type: none"> • Compliant with the requirements of AS3786 • Where multiple smoke alarms exist, they should be interconnected as per BCA Specification E2.2a or BCA 3.7.5.2 requirements • Dual supply including 240Vac hardwired to mains power with fixed rechargeable (Lithium) battery backup (10 years battery life expectancy) – with minimum 2 months battery standby • Where wireless interconnection is used it shall be of a type approved by a Codemark or other BCA recognised accreditation body and compliant with AS/NZS 4268:2012 <p>Material and/or Manufacture</p> <ul style="list-style-type: none"> • Polycarbonate body • Water/dust ingress rating (IP) must be suitable for the installation environment • Fixings must be suitable for the installation environment • Wire guard/cage shall be either <ul style="list-style-type: none"> ○ Mild steel with corrosion resistant polyester coating (internal) ○ Stainless steel (external) <p>Installation</p> <ul style="list-style-type: none"> • Install in accordance with manufacturing instruction including required fixing detail appropriate to the installation substrate <p>Certification</p> <ul style="list-style-type: none"> • As per Work Requirements 	
Warranty	Minimum 10 year written warranty – Alarm	

2.15.3 Heat alarm

Component		Detector / Alarms
Sub-component		Heat alarm
Need	Replace with new interconnected heat alarm	
Requirement	<p>General</p> <ul style="list-style-type: none"> To current Australian Standards Heat alarm Includes wire guard where required <p>Performance</p> <ul style="list-style-type: none"> Compliant with the requirements of AS1603.3 Where multiple smoke or heat alarms exist, they should be interconnected as per BCA Specification E2.2a or BCA 3.7.5.2 requirements Dual supply including 240Vac hardwired to mains power and battery backup <p>Material and/or Manufacture</p> <ul style="list-style-type: none"> Polycarbonate body Water/dust ingress rating (IP) must be suitable for the installation environment Fixings must be suitable for the installation environment Wire guard/cage shall be either <ul style="list-style-type: none"> Mild steel with corrosion resistant polyester coating (internal) Stainless steel (external) <p>Installation</p> <ul style="list-style-type: none"> Install in accordance with manufacturing instruction including required fixing detail appropriate to the installation substrate <p>Certification</p> <ul style="list-style-type: none"> As per Work Requirements 	
Warranty	Minimum 5 year written warranty Alarm	

2.15.4 Vibrating and visual alarm device

Component		Detector / Alarms
Sub-component		Vibrating and visual alarm device
Need	Smoke alarm notification for occupants with hearing impairment	
Requirement	<p>General</p> <ul style="list-style-type: none"> To current Australian Standards Vibrating and visual alarm device to alarm occupants with hearing impairment Covers both hardwire and wireless units <p>Performance</p> <ul style="list-style-type: none"> Compliant with the requirements of AS1603.17 Dual supply including 240Vac hardwired to mains power and battery backup Where wireless interconnection is used it shall be of a type approved by a Codemark or other BCA recognised accreditation body and compliant with AS/NZS 4268:2012 <p>Material and/or Manufacture</p> <ul style="list-style-type: none"> Polycarbonate body Water/dust ingress rating (IP) must be suitable for the installation environment <p>Installation</p> <ul style="list-style-type: none"> Install in accordance with manufacturing instruction <p>Certification</p> <ul style="list-style-type: none"> As per Work Requirements 	
Warranty	Minimum 1 year written warranty – Alarm	

2.15.5 Hush button

Component		Detector / Alarms
Sub-component		"hush button"
Need	Hush button to temporarily delay SOU smoke alarm.	
Requirement	<p>General</p> <ul style="list-style-type: none"> • To current Australian Standards • Hush button to temporarily delay ("Silence") SOU smoke alarm. • Includes all cabling and cable ducting required for installation <p>Performance</p> <ul style="list-style-type: none"> • Activation of the "hush" button shall temporarily desensitise the alarm unit for a period of approximately 5 min to allow an occupant to clear smoke in the event of a nuisance event <p>Material and/or Manufacture</p> <ul style="list-style-type: none"> • Polycarbonate body • Water/dust ingress rating (IP) must be suitable for the installation environment • Fixings must be suitable for the installation environment <p>Installation</p> <ul style="list-style-type: none"> • Install in accordance with manufacturing instruction including required fixing detail appropriate to the installation substrate <p>Certification</p> <ul style="list-style-type: none"> • As per Work Requirements 	
Warranty	Minimum 5 year written warranty	

2.15.6 Heat detector

Component		Detector / Alarms
Sub-component		Heat detector
Need	Replace with new heat detector to suit kitchen or other applicable area	
Requirement	<p>General</p> <ul style="list-style-type: none"> To current Australian Standards Heat detector with matching base and wire guard. Includes wire guard where required <p>Performance</p> <ul style="list-style-type: none"> Compliant with the requirements of AS7240.5 and AS1670.1 24Vdc ensuring current draw is suitable for panel or supply device Conventional or analogue addressable to match existing unit Activation temperature and activation rise in rate (if applicable) to match existing unit <p>Material and/or Manufacture</p> <ul style="list-style-type: none"> Polycarbonate body Water/dust ingress rating (IP) must be suitable for the installation environment Fixings must be suitable for the installation environment Wire guard/cage shall be either <ul style="list-style-type: none"> Mild steel with corrosion resistant polyester coating (internal) Stainless steel (external) <p>Installation</p> <ul style="list-style-type: none"> Install in accordance with manufacturing instruction including required fixing detail appropriate to the installation substrate <p>Certification</p> <ul style="list-style-type: none"> As per Work Requirements Baseline data/modification to THE PRINCIPAL'S inventory records including modification to AS1670.1 – Section A.4 Functional check to be conducted in accordance with AS1670.1 – Section A.3 	
Warranty	Minimum 5 year written warranty – detector	

END OF COMPONENT REQUIREMENTS - PART 2

Part 3 Timber Schedule and Drawing Details

To be used as a guide only

	Drawing No.	Title
1	TS01	Schedule of Timber Species, Durability Ratings
3	KD02	Kitchen Fitments, Floor Units 'E', 'F', 'O'
4	KD03	Kitchen Fitments, Corner Unit 'T'
5	KD04	Kitchen Fitments, Servery Unit
6	KD05	Kitchen Fitments, Wall Unit 'C', 'D', 'S'
7	KD06	Kitchen Fitments, Pantry and Broom Cupboards 'G' & 'H'
8	KD07	Kitchen Fitments, Breakfast Bar Unit 'N'
9	KD08	Kitchen Fitments, Medicine Cabinet Wall Unit Type 'C'
10	KD09	Kitchen Fitments, Microwave Cupboard
11	KD10	Kitchen Fitments, Cupboard over Refrigerator
12	KD11	Kitchen Fitments, Floor Unit including Wall Oven Shelf
13	MF01	Lapped Paling Fence
14	MF02	Closed Paling Fence
15	MF03	Frame Types
16	MF04	Footings
17	MF05	Steel Gate Frames
18	MF06	Vehicular Gate Frames (Back Fences)
19	HER01	Conservation Trade Practices – Masonry Joint Repair

TS01 – SCHEDULE OF TIMBER SPECIES, DURABILITY RATINGS

Application	Timber species or minimum Durability class (AS5604.2005)	Timber Finish	Relevant Australian Standards	Preservative Treatment rating For softwood where Specified
Structural timbers Exposed to weather	Class 1 or 2 (Where softwoods meet durability class 1 or 2 preservative treatment is not required)	Sawn		H3
Sub-floor framing exposed to ground	Class 3 or better	Sawn		H4
Structural timbers not exposed to weather	Class 4 or better	Sawn		N/A
Fascias, barges	Oregon Ash type eucalypts (Immunised and reconditioned)	Select dressing Select	2858 2796	N/A
Weatherboards	Radiata Pine Cypress Western Red Cedar Hardwood Brush Box	Select " " " "	1495 (1973) O93 - 2796 "	H3
Mouldings	Sitka Spruce	Select dressing	2796	

NSW Land and Housing Corporation
Specialised Fire Safety Services Contract
Schedule 6 (Component Requirements)

(Reveals)	Oregon	"	2858	
	Western Red Cedar	Select	-	H1 (int) H3 (ext)
	Radiata Pine	"	1498 (1973)	
	Hoop Pine			
	Slash Pine			
	MDF			
Sills	Tallowwood	Select	2796	N/A
	Blackbutt	"	"	
	Red Mahogany	"	"	
	Crow's Ash	"	"	
	Western Red Cedar	"	"	
Window and door	Western Red Cedar	Select	-	N/A
Frames	Oregon	Select dressing	2858	
	Ash type eucalypts (Immunised and reconditioned)	Select	2796	
Strip flooring	Radiata Pine	Standard	1492 (1973)	H3
	Mixed Hardwood	"	2796	
	Cypress Pine	"	1810	
	Murray Red Gum	"	2796	
Internal joinery, Cupboard framing	Oregon	Select dressing	2858	N/A
	Ash type eucalypts (Immunised and reconditioned)	Select	2796	
	Sitka Spruce	Select dressing	2796	
	Radiata Pine	Select	1497 (1973),	
	MR Particleboard		1498 (1973)	
	MR Medium Density Fibreboard			
Paling fence posts	Class 2 or better	Struct. Grade 1	2082	H4 or H5) See
	Class 1	Struct. Grade 1	2082	H4 or H5) Note
Other fence posts	Eastern Australian hardwoods	Struct. Grade 3	2082	H3
Fence rails and palings	Radiata Pine (treated)			
	Cypress Pine			

NOTE: Where H4 or H5 is specified as an alternative, the required hazard rating will depend on the specific existing site conditions.

**NSW Land and Housing Corporation
Specialised Fire Safety Services Contract
Schedule 6 (Component Requirements)**

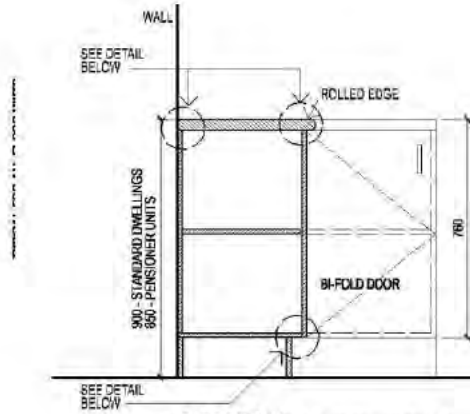

SECTION CORNER UNIT 'T-450'

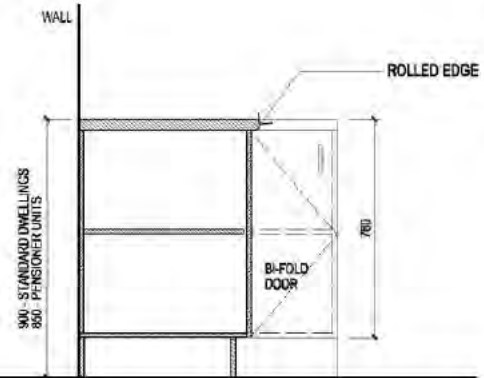

SECTION CORNER UNIT 'T-600'

ITS

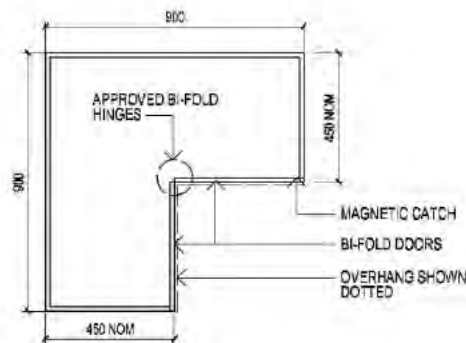

PLAN CORNER UNIT 'T-450'

NOTE: CENTRE LINE MEASUREMENT 1350MM

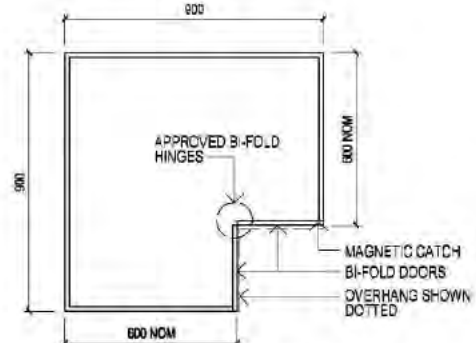

PLAN CORNER UNIT 'T-600'

NOTE: CENTRE LINE MEASUREMENT 1200MM

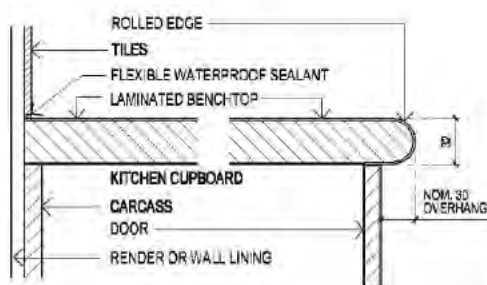

BENCHTOP DETAIL

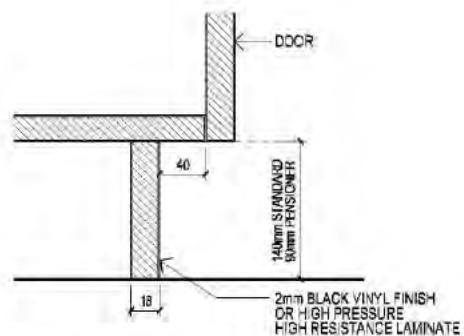

BASE DETAIL

**KITCHEN DETAILS : KITCHEN FITMENTS
CORNER UNIT 'T'**

KD 03

SCALE: NTS
DATE: 16.11.05

**NSW Land and Housing Corporation
Specialised Fire Safety Services Contract
Schedule 6 (Component Requirements)**

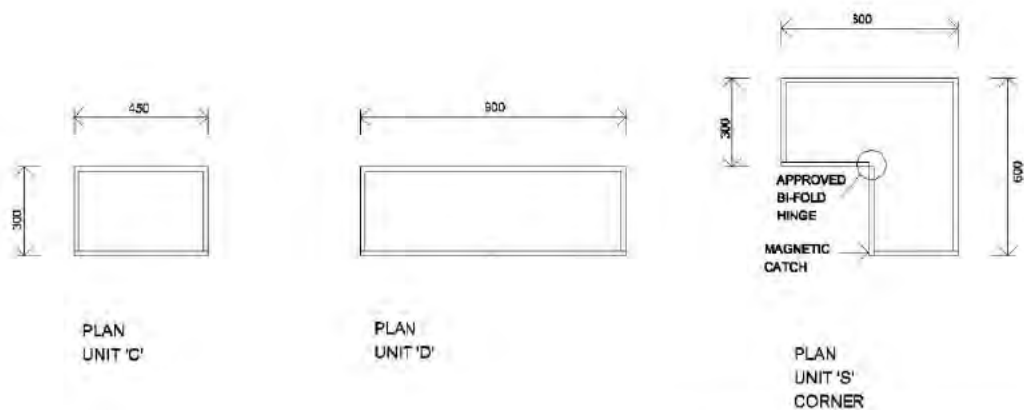
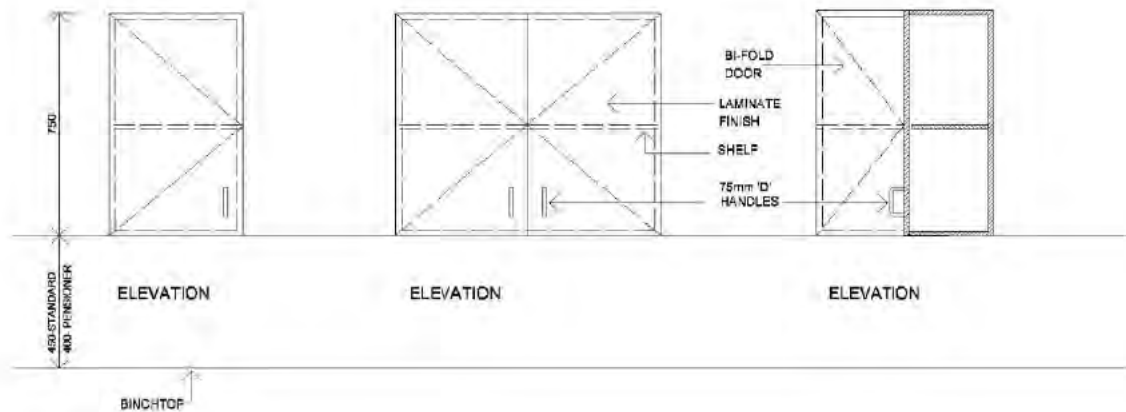

NOTE: CENTRE LINE MEASUREMENT 900MM

**KITCHEN DETAILS : KITCHEN FITMENTS
WALL UNIT 'C', 'D', 'S'**

KD 05
SCALE: NTS
DATE: 18.11.05

**NSW Land and Housing Corporation
Specialised Fire Safety Services Contract
Schedule 6 (Component Requirements)**

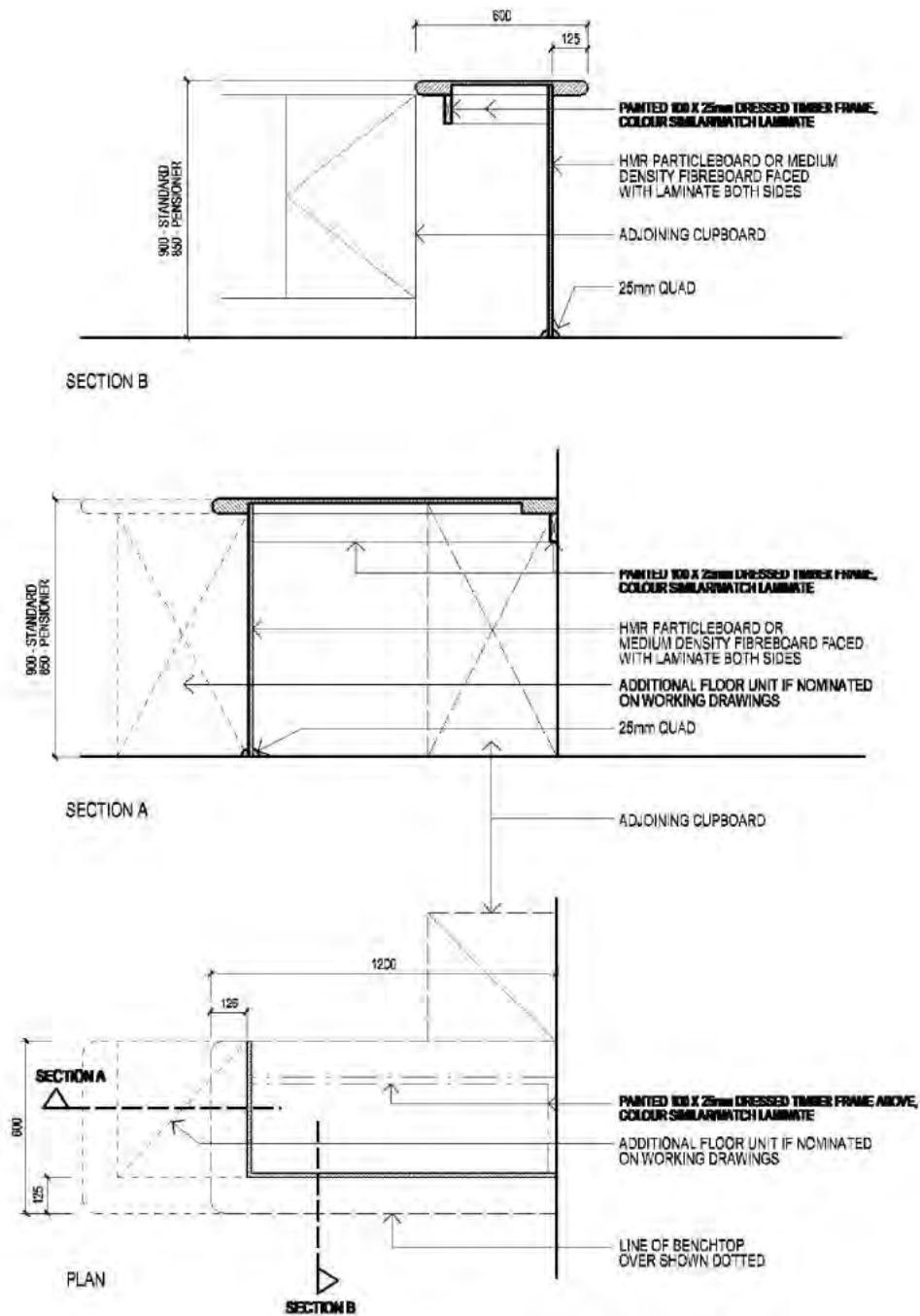

**KITCHEN DETAILS : KITCHEN FITMENTS
BREAKFAST BAR UNIT 'N'**

KD 07
SCALE: NTS
DATE: 18.11.05

S
1'
—
6
S
15

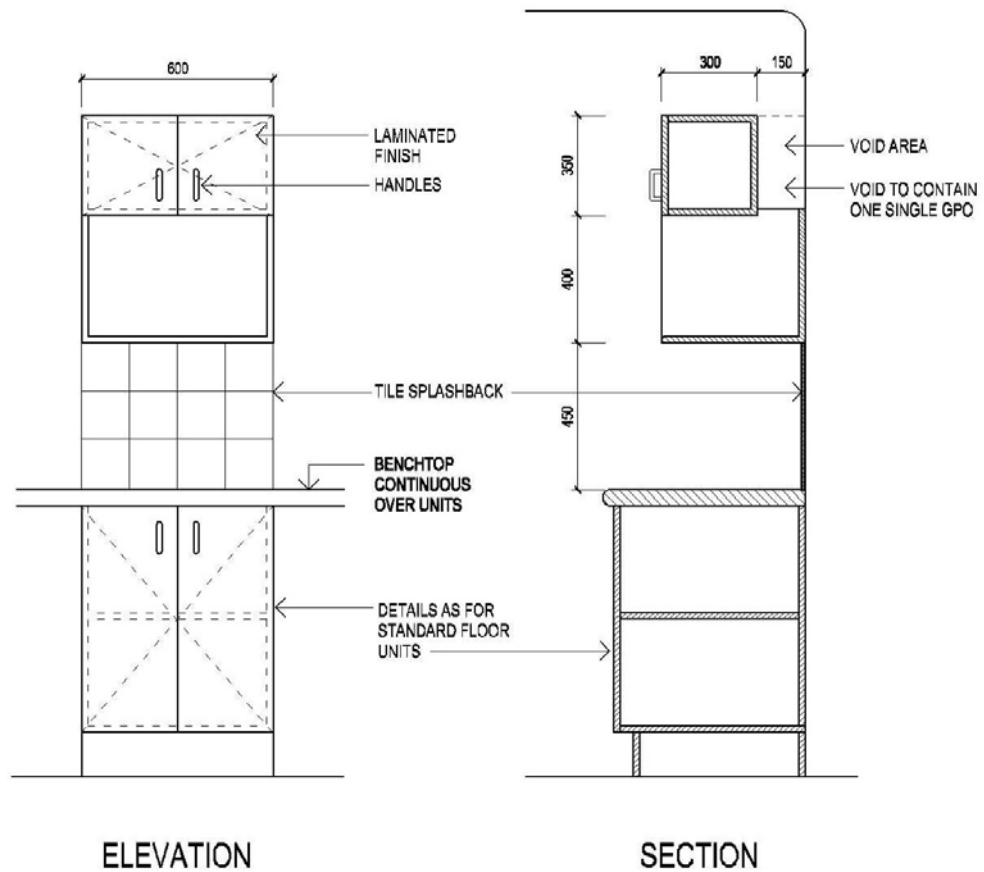

KITCHEN DETAILS : KITCHEN FITMENTS
STANDARD FLOOR UNIT & MICROWAVE CUPBOARD

KD 09
SCALE: NTS
DATE: 16.11.05

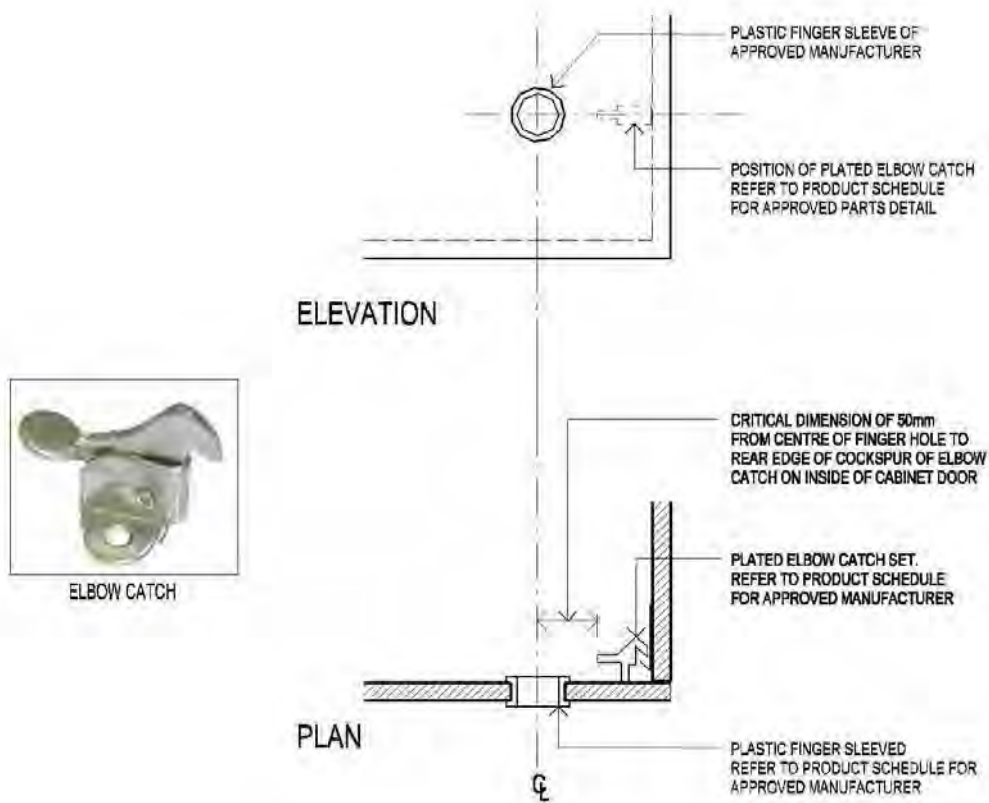

DETAIL OF LOCKING SYSTEM TO MEDICINE CABINET

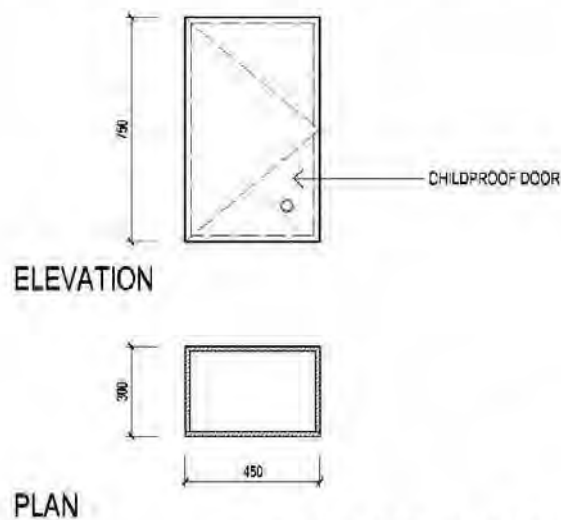

KITCHEN DETAILS : KITCHEN FITMENTS
CHILDPROOF MEDICINE CABINET WALL UNIT TYPE 'C'

KD 08
SCALE: NTS
DATE: 16.11.05

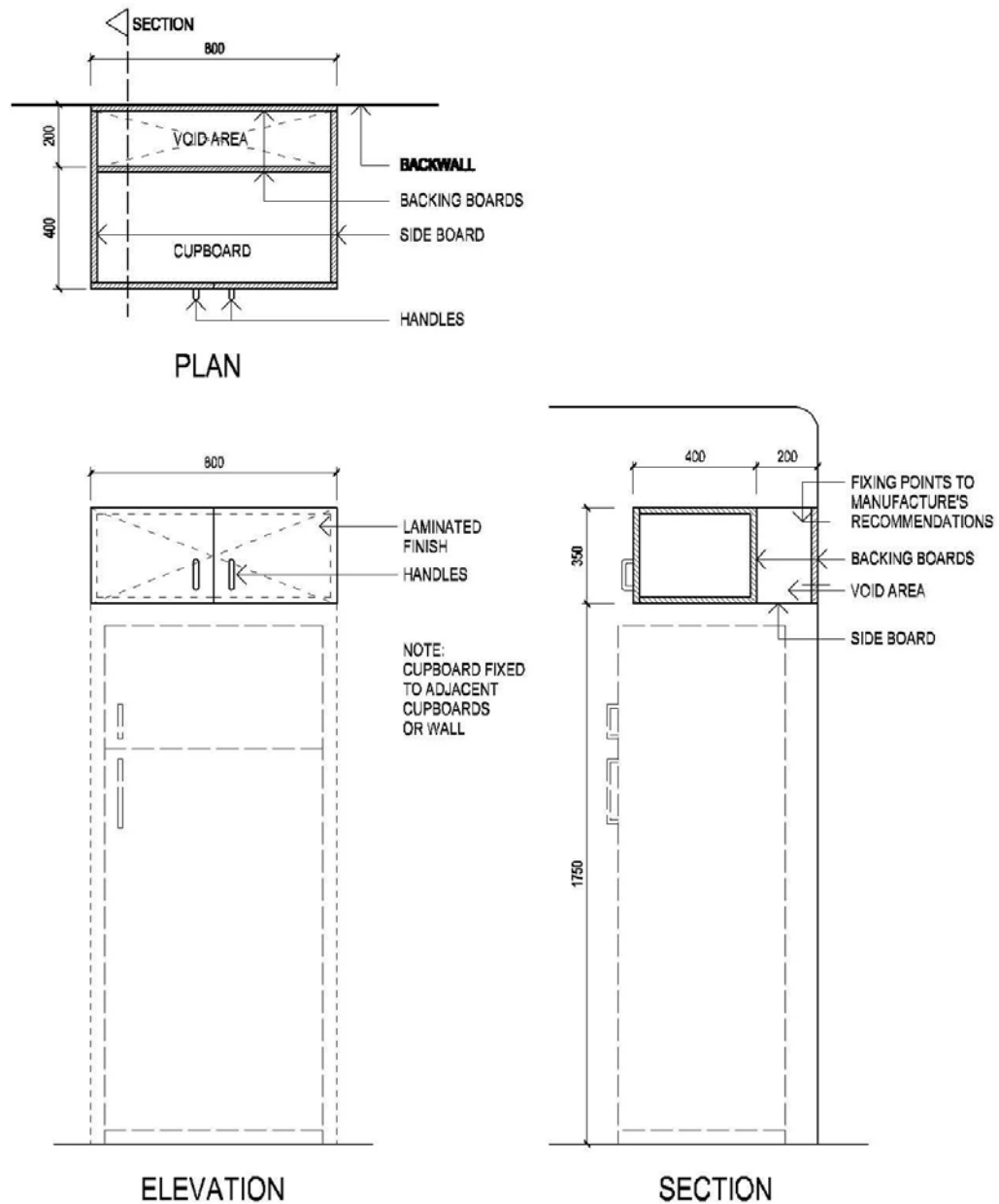

KITCHEN DETAILS : KITCHEN FITMENTS
CUPBOARD OVER REFRIGERATOR

KD 10

SCALE: NTS
DATE: MARCH 2004

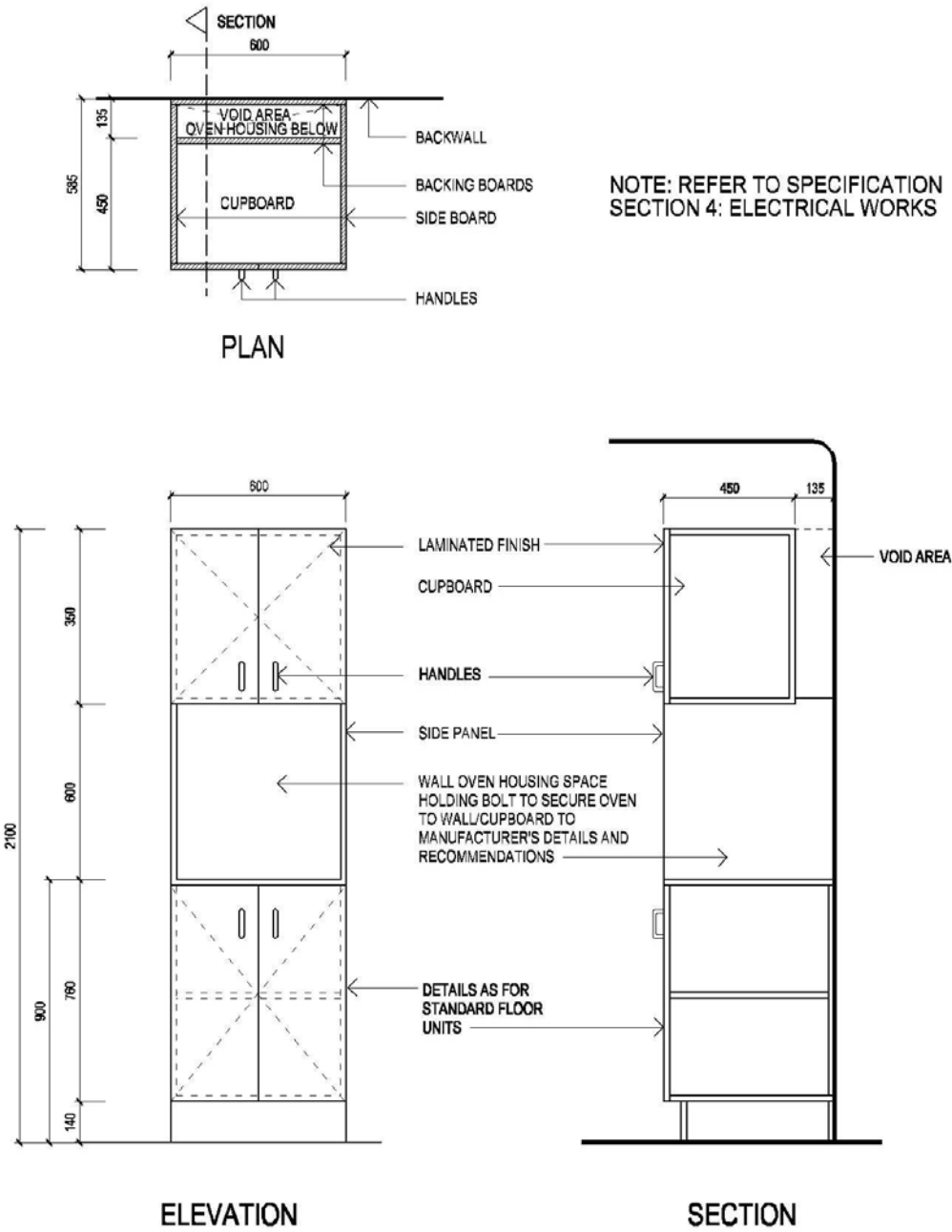

KITCHEN DETAILS : KITCHEN FITMENTS
FLOOR UNIT INCLUDING WALL OVEN SHELF

KD 11
SCALE: NTS
DATE: 12.12.05

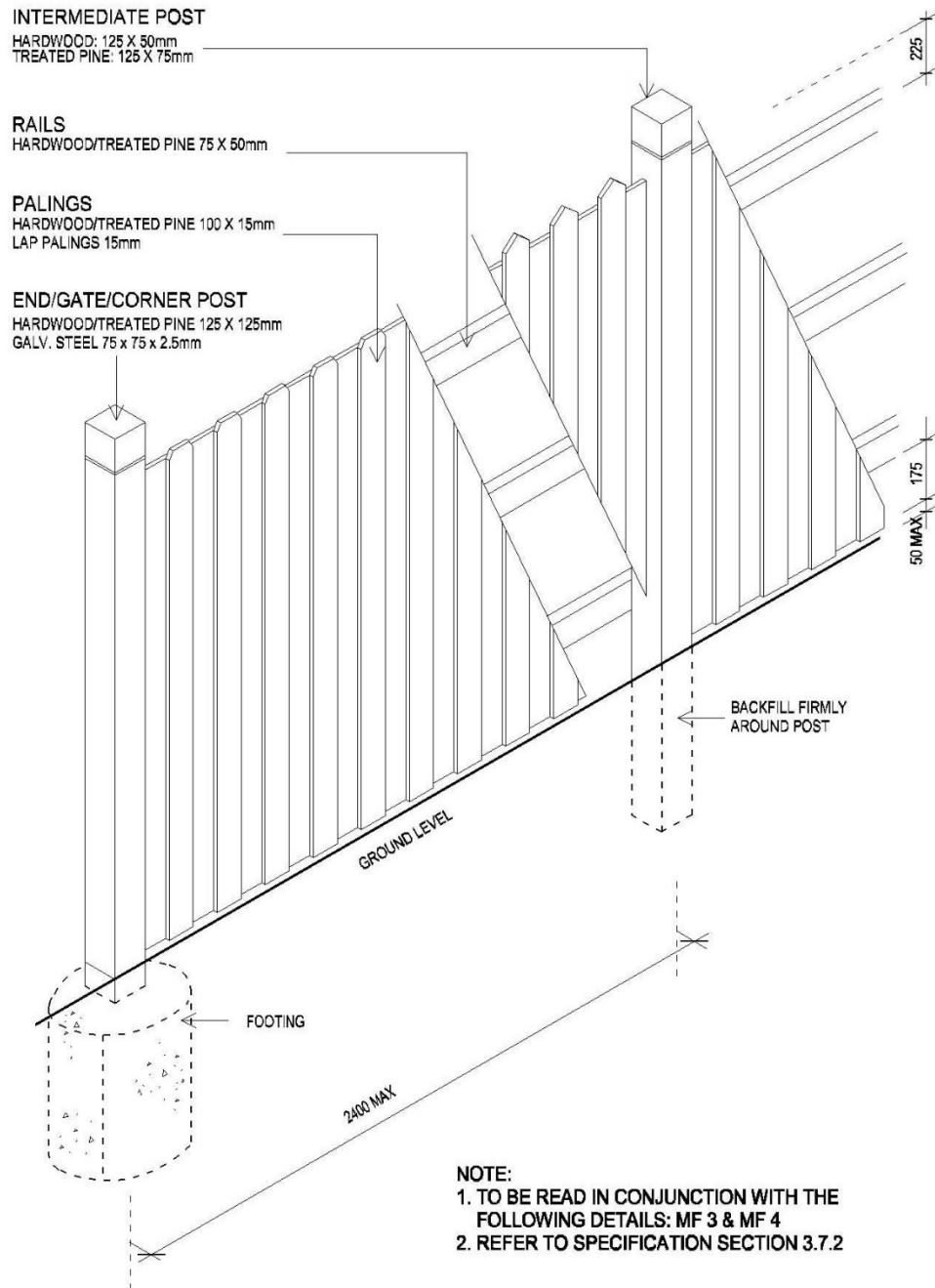

LAPPED PALING FENCE

MF 01

SCALE: NTS
DATE: 18.11.05

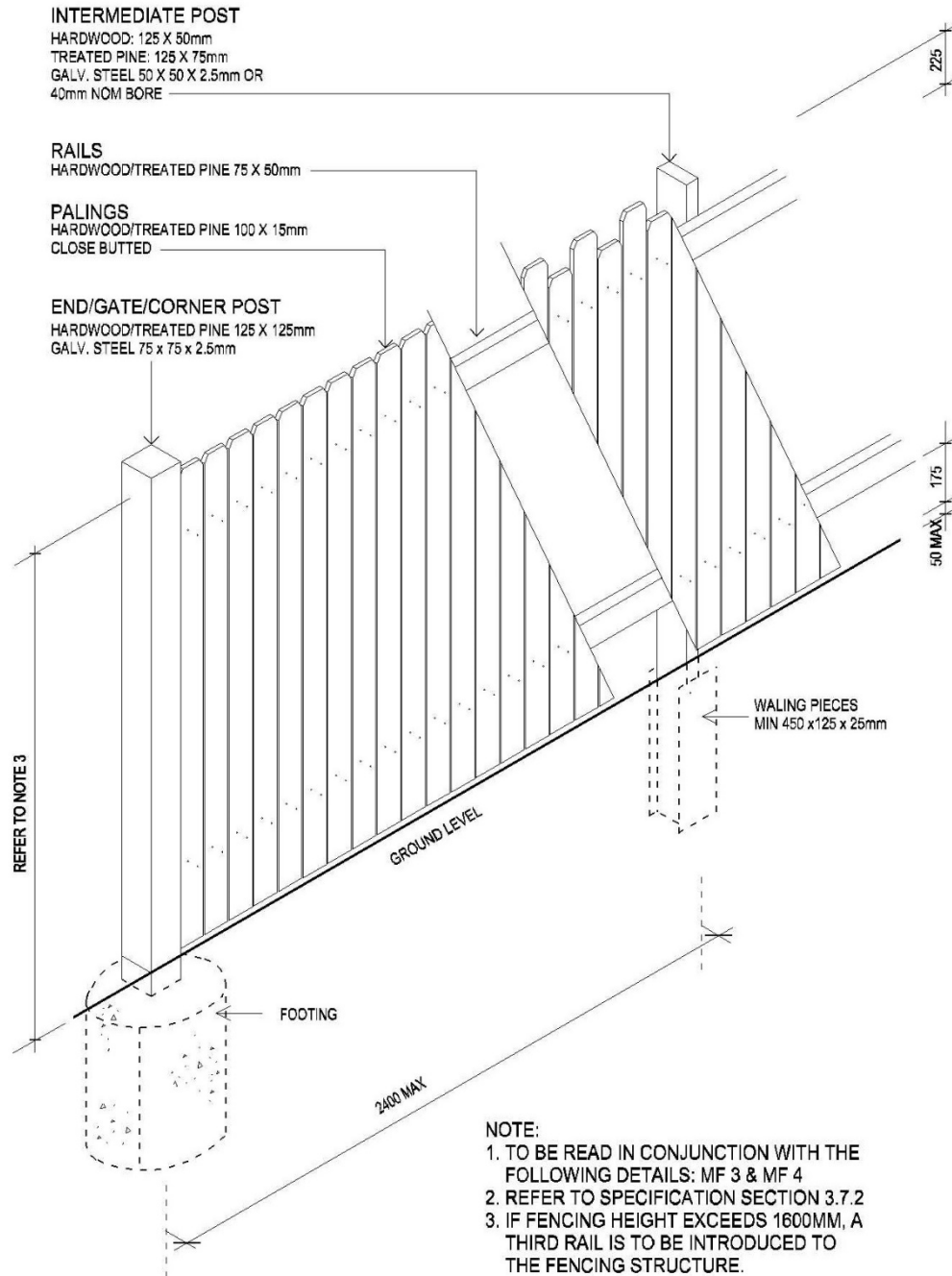

CLOSED PALING ENCE

MF02

SCALE: NTS
DATE: 18.11.05

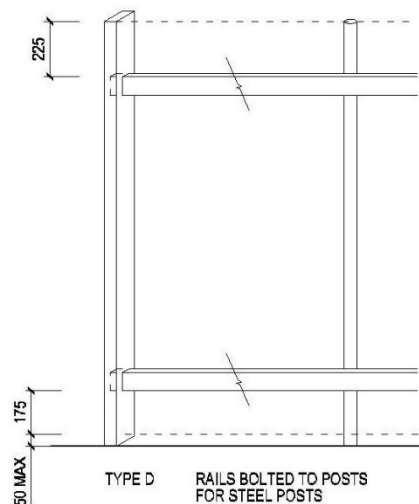
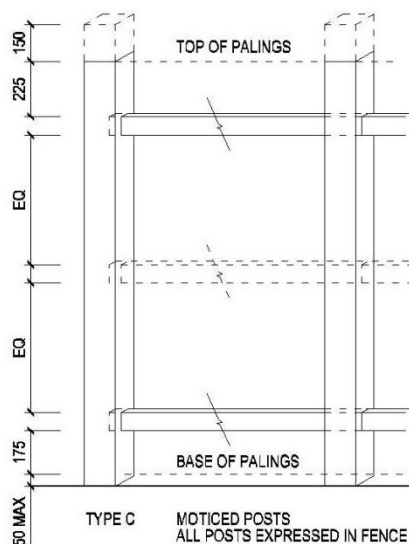
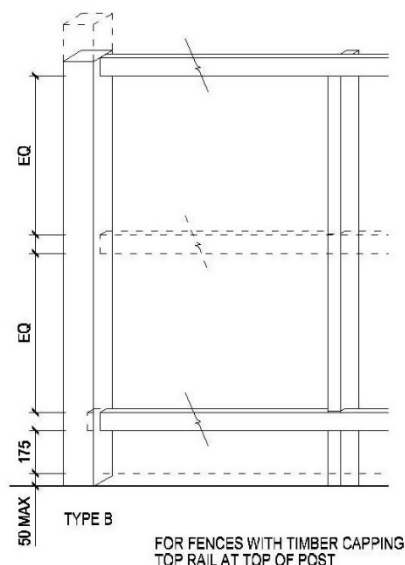
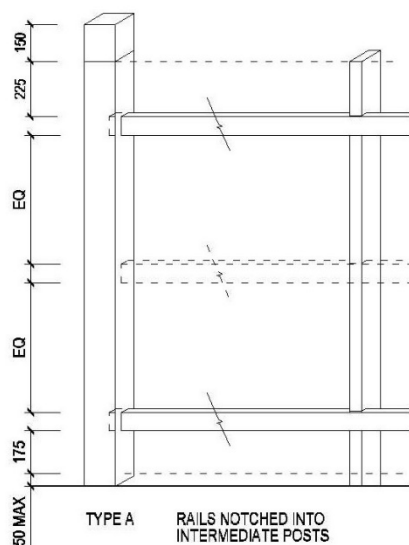

NOTES:

SPACING - 2400mm MAXIMUM BETWEEN POSTS.

POST

- SET VERTICALLY, WEATHERCUT TOPS OF TIMBER POSTS WITHOUT DECORATIVE TOPS.
- INSTALL POSTS AS DETAILED ON FOOTINGS SHEET NO MF 4
- PAINT IN-GROUND HARDWOOD WITH TYPE A CREOSOTE TO A.S. K55 TO 100mm ABOVE GROUND
- CAP GALVANISED STEEL POSTS WITH PURPOSE MADE PUSH ON FRICTION CAPS.

RAILS

- STOP MORTICE RAILS MIN. 38mm INTO TIMBER CORNER, END AND GATE POSTS
- JOIN AT ALTERNATE POSTS. TAPER AND SPLICE TOGETHER AND NAIL IN MORTICES
- FIX TO GALVANISED STEEL POSTS AND NOTCHED TIMBER POSTS USING 10mm DIAM. GALV BOLT & WASHER
- USE THREE RAILS WHERE SPACING BETWEEN RAILS IS GREATER THAN 1100mm AND FOR ALL LAPPED PALING FENCES
- FOR TIMBER CAPPED FENCES PLACE TOP RAIL AT TOP OF POST

FRAME TYPES

MF03

SCALE: NTS
DATE: 16.11.05

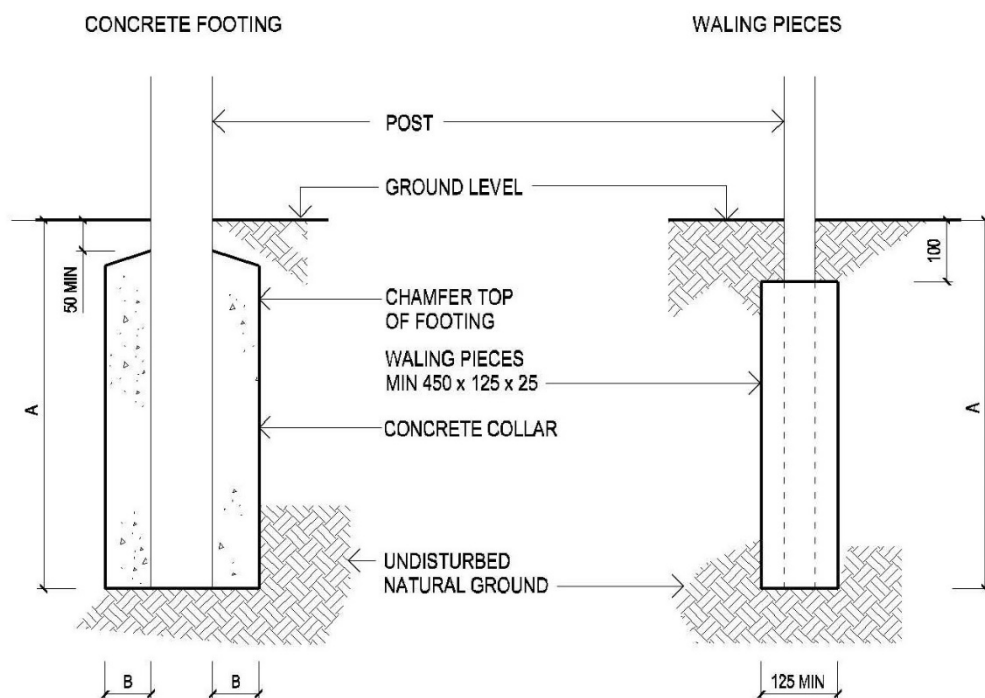

SOIL TYPE/FOOTING SIZE	A DEPTH (mm)	B COLLAR WIDTH (mm) ALL ROUND
A. SAND OR HIGH WIND	1000	300 MINIMUM
B. CLAY/LOAM	600	100 MINIMUM
C. ROCK	375	PACK HOLE WITH CONCRETE

NOTES:

CONCRETE FOOTINGS

- REFER TO SPEC SECTION 3.5
- EXCAVATE HOLE TO DIMENSIONS REQUIRED
- SURFACE OF POST IN-GROUND IS TO BE CLEANED TO ENSURE ADEQUATE BONDING WITH CONCRETE
- IN-GROUND SECTION OF ALL POSTS TO BE FULL DEPTH OF FOOTING NOTED IN TABLE
- CONCRETE TO BE 4:2:1 AGGREGATE, SAND, CEMENT MIX OF 15MPa STRENGTH, PACKED INTO HOLE
- CHAMFER TOP OF FOOTING, FINISH MAX. 50mm BELOW GROUND LEVEL
- FOOTINGS TO BE PROVIDED FOR ALL GALVANISED STEEL POSTS
- INSTALL FOOTINGS TO TIMBER CORNER, GATE AND END POSTS
- FOR PICKET, LATTICE AND SHEET STEEL FENCES INSTALL FOOTINGS TO ALL POSTS
- IN SOLID ROCK POST TO BE MIN. 375mm INTO GROUND PACKED AROUND WITH CONCRETE

WALING PIECES

- INSTALL 2 OFF 450(MIN) x 125 x 25mm TIMBER WALING PIECES, ONE TO EITHER SIDE OF 50 x 125mm INTERMEDIATE TIMBER POSTS WITHOUT FOOTING TO FINISH 100mm BELOW GROUND LEVEL.
- DOUBLE NAIL TO POST

FOOTINGS

MF04

SCALE: NTS
DATE: 16.11.05